



THE ROYAL BURGH

LANARK

EST 1140

Local Place Plan 2025



Foreword

Lanark is a historic town steeped in tradition. Over the last few years it has been impacted by the work of Discover Lanark Business Improvement District (BID), Lanark Community Development Trust (LCDT) and The Royal Burgh of Lanark Community Council. This Local Place Plan reflects our collective vision and ideas for a future that honours our past while embracing the challenges and possibilities of the present. Discover Lanark's Blueprint for Lanark (2021-2031) and LCDT's Vision for Lanark document (2020-2030) have both been used as the basis for this place plan, along with local public consultations. The plan aims to make Lanark a greener, more prosperous place to live, work and visit, and highlights the area's rich heritage and potential for community wellbeing, business and tourism alike.

Drawing upon the rich tapestry of our history, we envision a Lanark where heritage and modernity coexist harmoniously, where residents and visitors alike feel a sense of belonging and pride.

This plan is a road map for achieving our aspirations. It outlines priorities, identifies our proposed projects and sets out the challenges we currently face. From preserving our heritage, promoting economic growth and relieving the economic disparity, to enhancing our green spaces and improving our infrastructure. This plan is a concise document containing the key areas we wish to address.



Before and After photos of the
Wallace House Site

Table of Contents

03 Introduction

04 Local Place Plan
Area Map

05 Wider Area Land
Use Map

06 Conservation and
Listed Buildings

07 Description and
Context of the Area

07-10 Community
Engagement

11-12 Assets, Opportunities,
Needs and
Challenges

13 Introduction of Proposals

14-15 Proposals:
Transport and
Infrastructure

16 Proposals:
Heritage and Buildings

17 Proposals:
Health and Care

18-20 Proposals:
Housing

21-22 Proposals:
Public Spaces

23-27 Appendix



Introduction

It is recognised how important the vibrancy and vitality of Lanark town centre is to the quality of life of local residents and to the experience of visitors to the area.

This plan seeks to enhance Lanark as a people-centred town. At its heart is how residents and visitors experience the town; from points of entry to wayfinding to public realm to enabling new events and activity. Creating a more welcoming, better designed, greener and more diverse town will help to support and sustain local businesses and the wider community through these uncertain times to a more prosperous future.

Amongst the challenges currently facing the town are:

- A core traditional retail sector struggling in the face of competition from online shopping, out of town retail and nearby larger retail centres.
- A transport infrastructure under pressure from traffic congestion, as well as inadequate provision for parking in key areas of the town.
- A historic core with character but containing many buildings in poor condition and some key buildings currently vacant
- An absence of high-quality public spaces and piecemeal public realm.
- A limited tourism support infrastructure
- Poor access to services across a health and care sector under pressure from patient numbers and needs
- The need to support a diverse housing sector that provides suitable and affordable housing for a varied and changing population



Lanark has a unique story to tell, and a character, culture and heritage which we want to celebrate. At the same time, it needs to remain relevant for the future through diversifying, animating and at times transforming the town's buildings, streets and public spaces, encouraging the town to be the vibrant heart of the community where people meet, socialise, shop, eat and exercise.

Our Local Place Plan

Area map

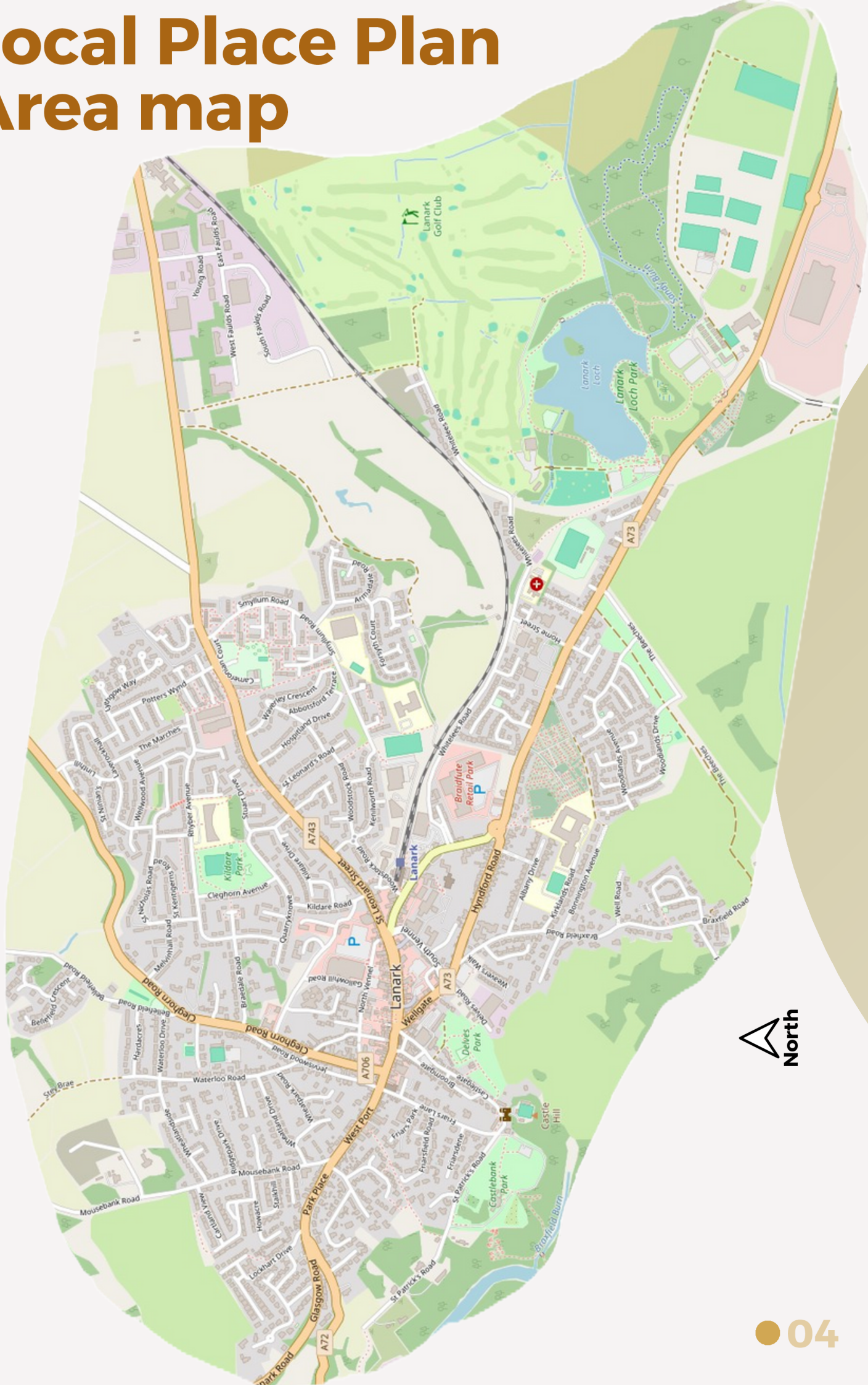

Surrounding area

showing land use

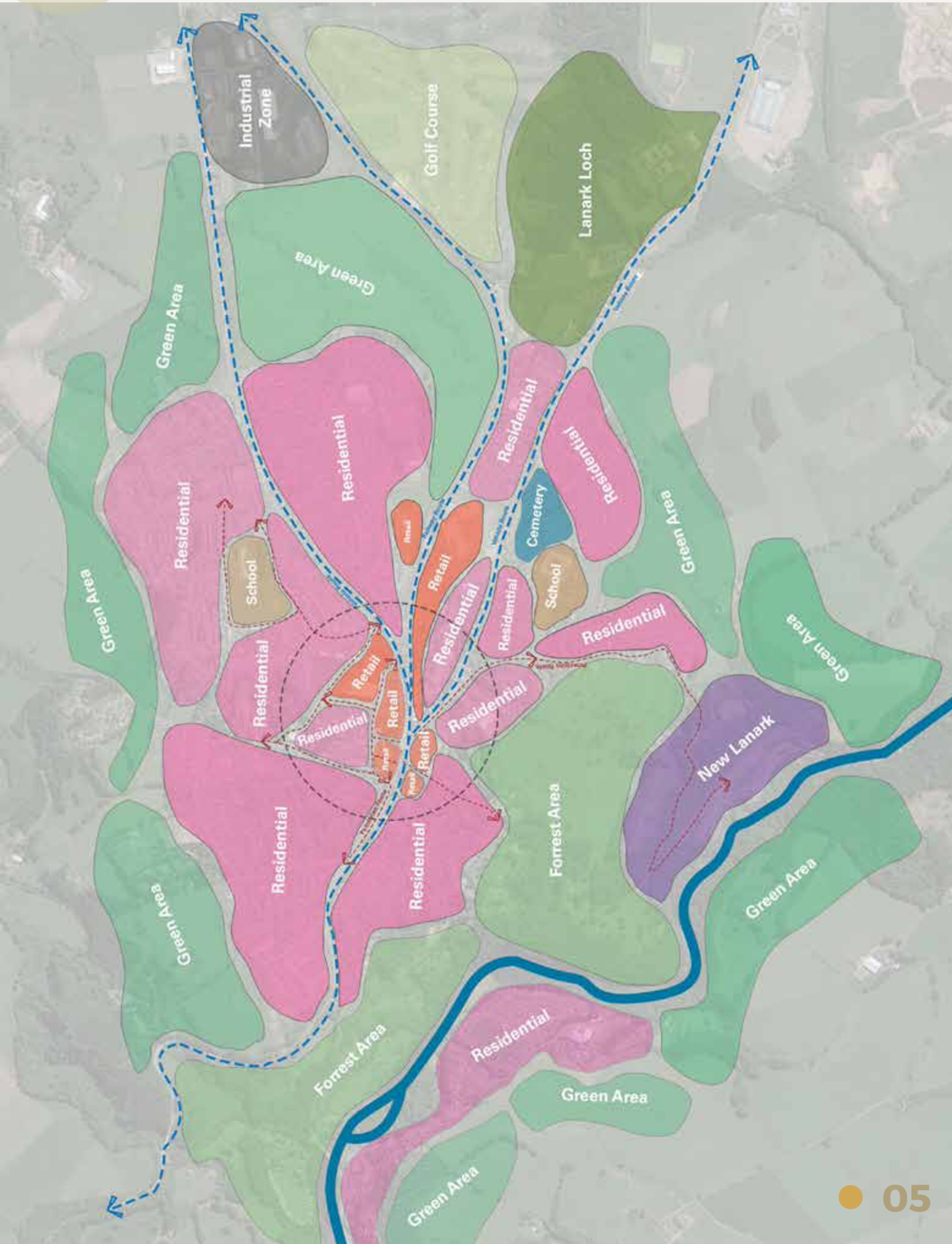



- Conservation Area Boundary
- A Listed
- World Heritage Site
- B Listed
- C Listed

Conservation & Listed Buildings

Description and Context of the Area

DEMOGRAPHICS

Lanark, with a population of approximately 8,943 (2022 census), serves a predominantly agricultural hinterland and exhibits a diverse age range. While South Lanarkshire's unemployment rate has decreased to 2.9% (2023), economic inactivity has risen to 21.2%, likely due to increased retirement and health-related withdrawals from the workforce. Of the 4,100 economically active residents (2022), 179 are unemployed but able to work. A significant proportion of Lanark's 3,985 employed residents (2022) work from home (1,148) or locally (within 10km, 1,105), though car use remains the dominant mode of transport (2,034). 427 people travel on foot and only 173 use public transport (Bus, Trains, Subway and trams).

Married couples constitute the largest household type (3,719), followed by single-person households (1,686). There are 635 single-parent families, roughly evenly split between those with one and two or more dependent children.

Most residents live in houses (6,805) whether that is a house, bungalow, detached, semi-detached or end-terrace, compared to flats/apartments (1,950). Of Lanark's 4,449 dwellings, approximately 97% are occupied, with 2% vacant, including 67 long-term empty properties.

PREVIOUS RESEARCH AND COMMUNITY ENGAGEMENT

Various Consultations have been held from 2019-2025 all of which received a healthy response rate with comprehensive feedback. These have all contributed to plans for Lanark. The results from some of these can be found below.

KEY POINTS FROM THE RESULTS OF COMMUNITY ENTERPRISE CONSULTATION OCTOBER 2021:

- 55% rate their experience of Lanark as 'good': 16% 'great' and 24% as 'ok.' General sense that Lanark is pretty good but not fulfilling its potential.
- Most highly rated aspects: green space and natural environment / community spirit / pride in heritage
- Most poorly rated aspects: local economy and jobs /ability to influence what happens in the town / access to health and wellbeing services
- What people like (most mentions): green space, countryside and walks / community spirit (neighbours and friends) / adequate shopping and local businesses / good range of local activities available / history and culture.
- What people dislike (most mentions): traffic / derelict buildings and empty retail units / poor shopping experience/ unattractive town centre and unkempt streets.
- Groups which are most poorly served in Lanark: teenagers and young people, followed by children. No incentives for this age group to stay or take pride in the area. Impact of Covid: need for more information and better access to information about what's happening at a community level / increased need for more outdoor provision / better health care services / assistance for isolated older people.

Community Engagement cont.

VISION FOR LANARK 2020-2030 CONSULTATIONS:

These took place in three parts: a local organisations questionnaire: a general community questionnaire and a young people's photo and caption competition. The exercise was designed to bring together a view on the kind of place that people wanted Lanark to be, as a starting point for this Development Strategy.

In over 250 formal responses the community responded constructively and passionately about the future of their town and its potential. The need for strategic change and improvements was widely recognised by both local organisations and individuals. A systematic review of all of the feedback identified eight areas of interest, of which 5 are relevant to our Local Place Plan, which we have used as a baseline.

1.1 Identity, promotion and collaboration

- Coordinated approach to promoting Lanark's natural and cultural heritage
- Coordinated priorities for the town and prioritising funding aspirations accordingly.
- Coordinated communications plan for promotion of what is going on where.
- Improved marketing to increase footfall in the town.

1.2 Local Businesses and town centre

- Restore historic frontages, conserve heritage buildings and improve the visual appeal of the town centre.
- Increase number of attractive outdoor spaces, public seating, pedestrianised areas, while maintaining general upkeep.
- Improved car parking in the town.

1.3 Sustainable transport

- Transport plan within the town for residents and visitors
- Reintroducing the Edinburgh train and improving the bus connections in the town in sync with train times.

1.4 Visitor experience

- Upgrade the visitor experience in the town and around Lanark through events and attractions such as a mural trail.
- Invest in and promote the areas green spaces.

1.5 Community

- Increase housing for elderly.
- Diversify types of housing available in Lanark.

Community Engagement cont.

LOCAL PLACE PLAN CONSULTATION 9/11/24:

We had a decent response, on the 9th with the majority agreeing with our proposals, but also some additional suggestions.

- The Old Lidl Car Park has become vital to locals and visitors alike, when events are on this is felt more so. Locals feel this should be kept on top of any additional parking mentioned.
- Introducing a link for cars between Woodstock Road and St. Leonards street to reduce congestion in the Woodstock Road/ Bannatyne Street area.
- More recognition for the site of Lanark Castle, murals and sculptures along with more information on the history of the site to be placed at the Lanark Thistle bowling club.
- More opportunities for young people once graduating locally, to encourage further education and encourage workforce development in the area.

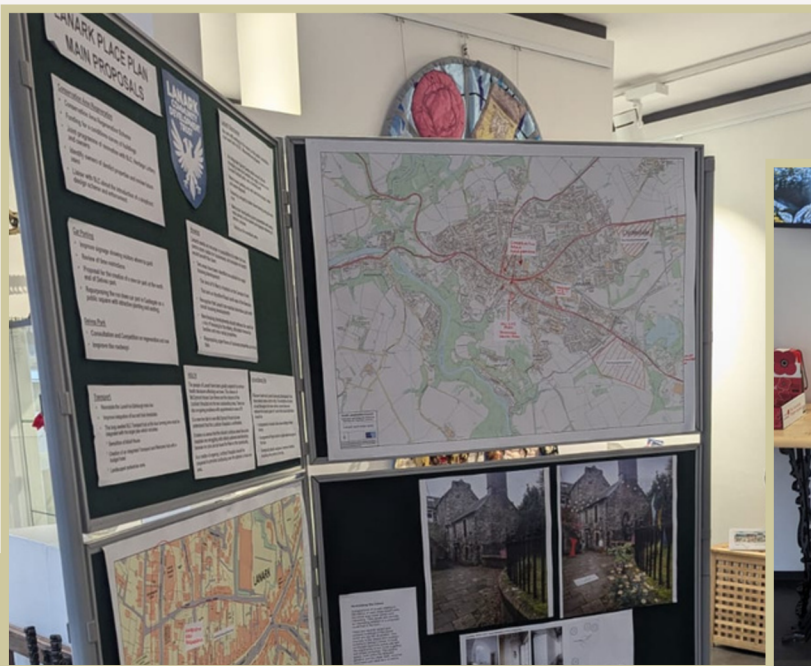

Community
Consultation on 9/11/24

Community Engagement cont.

LOCAL PLACE PLAN CONSULTATION MARCH 2025

This Consultation was held from the 11/3/2025 -23/3/2025 and was hosted online. After creating a rough draft Local Place Plan, we used this to gain feedback during our second consultation. With 50 responses people gave comprehensive feedback, some of which has been noted on the following page.

Feedback Gained from March 2025 Consultation

The feedback gained from this consultation was comprehensive and the full results will be linked in the appendix. Some key points raised are:

- There is not enough for young people to do in Lanark and this can lead to antisocial behaviour.
- Transport services need to be improved and support for an Edinburgh train service leaving from Lanark.
- Congestion in the town needs to be revisited and parking better signposted as well as increased.
- The Heritage of Lanark should be utilised and protected using heritage town centre plans and stricter enforcement of standards within the conservation area.
- General negative comments about the health care in Lanark. Many appreciate the work that the PPG and PAG are doing.
- The introduction of public toilets is important to the town and is believed to be essential for attracting more tourism.



Star Graph illustrating participants' ratings across various aspects of Lanark's community, infrastructure, and amenities.

Assets, Opportunities, Needs and Challenges

THE VISION – Drawing upon the potential of our unique cultural and natural heritage, Lanark and its environs will be a greener, more prosperous place to live, work and visit – proud of its past and confident in its future.

Assets

Historical Significance - The area of Lanark, contains one the best concentrations of natural and cultural heritage assets in rural Scotland. This rich heritage provides great benefits and potential for community pride as well as for business and tourism development. It's important to preserve the towns association with William Wallace and other historical figures and to use those links for the benefit of town.

Natural Beauty - Lanark's green spaces were identified as a priority in multiple consultations. Castlebank Park, Delves Park, Lanark Loch, Kildare Park and Lanark Racecourse are all used, some more than others, along with the walking trails throughout the area.

Community Spirit - Lanark is host to many community groups and organisations often working together for projects. Lanimers, a yearly celebration also contributes to the community spirit, encouraging schools and organisations to come together.

Proximity to major cities- Lanark is a 45-minute train journey or drive from Glasgow and about an hour from Edinburgh by car, and just under 2 hours away on public transport. It's a convenient day trip for visitors to both cities, and a convenient distance for commuters.

Opportunities

Tourism development- Lanark is within reasonable distance of both of Scotland's major cities, providing an opportunity to develop our assets and increase footfall in the town, Lanark is ideally located to encourage day visitors from across the central belt and beyond. Providing an opportunity to increase footfall and spend in and around the town.

Economic Diversification- With varied assets, Lanark is in a position to diversify its offer and create worthwhile experiences for locals and visitors alike. Opportunities exist for example: enhancing existing attractions, developing new experiences and supporting local businesses with green tourism.

Community Engagement- Opportunity exists to increase community engagement, involve local people in decision making and communicate regularly with local groups, organisations and individuals.

Sustainable development- Lanark being a small town lends itself to utilise the surrounding green spaces to increase renewable energy. Any new housing developments have the opportunity to become eco-housing, including renewables and sustainable waste practice.

Needs

Economic regeneration - Businesses in Lanark need assistance and more ways of harnessing the heritage and natural beauty of Lanark to increase tourism. Finding ways to encourage footfall in the town will enhance Lanark's potential to rejuvenate the local economy. Improving the appearance of the town could help to encourage new businesses and more people in the area to shop locally.

Improved Infrastructure - Transport Infrastructure in Lanark, has been one of the focuses derived by the Local Place Plan group. Buses are infrequent and unreliable, and train services have been cut to a bare minimum. Additionally, little effort has been made to integrate these services in a way that makes travelling around the local area seamless. This is a major issue as it is inconvenient for visitors and locals alike. Parking remains an issue. People who work in Lanark take up prime parking spaces, leaving few spaces for visitors. Lack of parking may prove a deterrent for those looking to move here, as well as visitors to the town.

Affordable and diverse housing - A combination of affordable, social and luxury housing is needed in Lanark.

Improved facilities for young people - Ages 12-18 are not well catered for in Lanark currently and new solutions need to be found to prevent further antisocial behaviour, which costs the council and local organisations money.

Challenges

Population decline- Lanark already has a large commuter population. On top of this over 20% (almost one third) of Lanark's population is over 65. This means that, of the 57% that are 18-64, it's likely they are commuters, students and in other professions meaning they are not in the town frequently. Losing this age group creates a brain drain and leaves little potential for those who want to stay and work in Lanark.

Economic hardship- Lanark like many Scottish towns has faced significant challenges in recent decades. A significant portion of Lanark's population struggles with poverty, limiting access to goods and services. Inadequate healthcare infrastructure further burdens residents with additional costs and hinders productivity.

Limited Employment opportunities - High unemployment rates and low-quality jobs also contribute to financial instability in the town. Lack of quality education and training also hinders the local economy and limit earning potential. This overall reduces the amount of educated working age people staying here for work and contributing to the local economy.

Environmental Issues - Whilst increasing renewables in the town, e.g. solar panels, is desirable, in practice this is difficult to achieve, due to the large number of old/listed buildings. Protecting and enhancing our green spaces, remains a challenge due to a lack of investment and reduced levels of maintenance.

Proposals

We took a number of feasible priorities from multiple previous vision documents for Lanark along with recent consultations to select the improvements we are proposing. These all aim to highlight the towns assets and address the most common issues felt by locals.

Our proposals are split into 5 groups, set out below and covered in more detail in the following pages.

Transport and Infrastructure

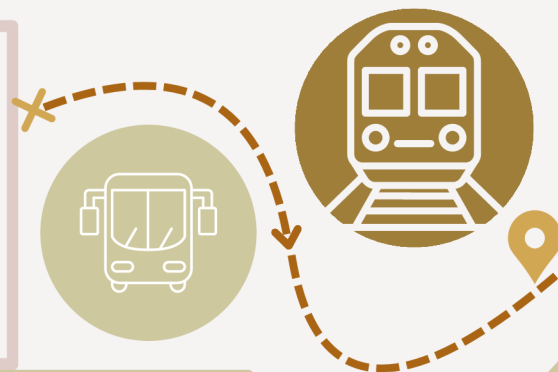

Heritage and Buildings



Health



Housing & Development



Public Spaces

Proposals: Transport and Infrastructure

St. Leonards street - Woodstock road link

Problem:

There are certain areas of Lanark that struggle with congestion, one of these is where Woodstock Road meets Bannatyne street. As Woodstock Road is a residential street and a lot of people don't have driveways, people park on the street, at the same time people are driving through and attempting to access either the Woodstock medical centre or the Leisure centre, both of which have parking but have created a bottle neck by having one road to access both.

Solution:

We are proposing the council should revisit their gyratory proposal and create a link road for cars to travel from St. Leonards Street to Woodstock Road to decrease congestion on the residential streets surrounding.

Parking

Problem

Parking in Lanark is poorly signposted, they are not always obviously accessible to visitors. People looking for places to park can often create congestion in the centre of town. Currently there are a handful of car parks around the town that are often full throughout the day. This is especially felt at the bottom of the High Street, though temporarily relieved since the closure of Lidl. However, this space will disappear when the property is redeveloped. The state of some of the car parks is also not great, with many having potholes and unkempt surroundings.

Solution:

Our proposal is to increase the signage for parking in town and turn the northeast sector of lawn in Delves Park into a landscaped car park providing 66 car parking spaces, more than double the current parking in Castlegate car park. There are also options within this to create a smaller car park that would use less of the green space. As well as this, we propose council works towards repairing the existing carparks so they are less hazardous. The Castlegate car park is covered in potholes has unkempt shrubbery surrounding it as well as commercial bins, we propose that all of these issues should be dealt with. For the commercial bins, a space in the car park could be set aside and hidden for the bins to be kept in.



Proposed car park design for
Delves Park.

Proposals: Transport and Infrastructure cont.

Public Transport

Problem

Lanark's inconvenient public transport system promotes car reliance, undermining the council's carbon reduction goals and local transport strategy. Investing in improving the service and promoting use of it would encourage a shift away from private vehicles. At the moment there is only one train an hour from the station, and lack of joined up timetables for buses and trains make train connections difficult. Limited and unreliable bus services to local villages and other towns are confusing for visitors and locals alike. Having only one train service running from the station can make journeys long winded and convoluted.

Solution:

Small adjustments to timetables could make travelling to and from Lanark much easier, ensuring that when a train comes in the buses to surrounding areas arrive around the same time. Having a live bus tracker at the bus station would help significantly. Secondly, bifurcating the line to Glasgow would open up the option for a train service to Edinburgh, this in turn would be likely to bring visitors from the capital more frequently.

Transport Hub

Problem:

The council has plans for the bus station and surrounding area. However, this does not address one of the problems within that area, Atholl House. When people arrive in Lanark via public transport Atholl house is the first thing they will notice, a derelict building falling to pieces and vandalised. Another issue within the transport hub is access. There are 2 entrances to the station and neither of them are particularly close to the designated disabled parking for the station, more entrances should be made to increase accessibility. The current plans for the area are not suitable and not in keeping with Lanark's heritage.

Solution:

Atholl House should be included in the councils plans to improve the transport hub. A compulsory purchase order of this building will give the council opportunity to demolish it and create a fit for purpose transport hub that can include public toilets, an information office and the possibility of a small hotel. Example plans can be seen below along with an artist's impression in the appendix.



View of Atholl house from station platform

Proposals: Heritage and Buildings

Problem

Many heritage buildings in Lanark's conservation area are in a deplorable state. The town has lost buildings within this area, and several are currently recorded as At Risk. Dilapidated buildings and obvious repair needs contribute to a sense of a depressed and declining townscape, exacerbated by vandalism and visible effects of anti-social behaviour. Conservation standards are not upheld by the council even considering Lanark's historic centre was recognized by SLC in their 2022 Tourism Strategy as one of three significant tourism towns in the region, alongside Strathaven and Biggar. With New Lanark, the Falls of Clyde, and the Royal Burgh, the Lanark cluster provides an international heritage resource deserving utmost protection and preservation. Notable deteriorations include:

- The former Clydesdale Bank building on the corner of Wellgate and Castlegate
- The ALVO building on Hope Street
- Former Browns Furnishings on Bannatyne street.

Solution:

Maintaining and restoring such structures to a high standard safeguards Lanark's unique identity, ensures future generations are aware of its historical significance, and enables deteriorating buildings to be used once again by the community.

To prevent further disintegration of building frontages and future falling hazards, it is imperative that a conditions survey is carried out on buildings within the conservation area, with follow-up from Building Control where necessary. More frequent assessments of buildings at risk will better preserve them and prevent future risks of falling slates and stone. The conservation area standards must be upheld to a high standard and the council should be enforcing these and reviewing them regularly.

Funding

The Lanark Vision Partnership was unsuccessful in their bid for major funding from Historic Environment Scotland and Heritage Lottery for the regeneration of the conservation area. We propose a further bid to fund larger building repair projects and smaller third-party grant schemes for private property repairs and training in traditional building skills for local tradespeople. We also suggest that a funding opportunity should be created/ sought for businesses, so that they are able to maintain any heritage property they take on.

Ownership

We propose identifying ownership of vacant premises, undertaking a review of potential future uses, and agreeing on priority regeneration projects. Several vacant and derelict buildings behind Lanark's closes could be renovated and repurposed. Improving communication with owners of vacant premises, facilitated by the council, would reassure the public that the building is being cared for.



Former Clydesdale Bank building



ALVO building



Former Browns Furnishings

Proposals: Health and Care

Care and Facilities

Problem

The services in Lanark are constantly deteriorating and diminishing. The people of Lanark have been greatly angered by various health decisions affecting our town. The closure of McClymont House Care Home and the closure of the Lockhart Hospital are the two outstanding ones.

Lanark constantly feels the loss of its cottage hospitals, and something is desperately needed to replace them.



Solution

It is too late now to save McClymont house, but we understand that the Lockhart hospital is mothballed. It makes no sense that this should continue when the acute hospitals are struggling with elderly patients' bed-blocking because no care can be found for them in the community.

As a matter of urgency, Lockhart Hospital should be reopened to provide continuing care for patients in their own area. This would also allow for a minor injuries unit further relieving stress on GP's and Hospitals.

GP services

Problem

The GP services at Lanark Woodstock Medical Centre are inadequate for the 14,000 patients they serve across ML8, ML11, and ML12. The absence of permanent doctors worsens the issue, leading to long waits and inconsistent care, particularly for those with chronic conditions. Heavy reliance on locum doctors, the extended healthcare team, and a telephone/online triage system compromises continuity and increases the risk of errors.

The extended hours clinic, meant to help those unable to attend during regular times, has limited availability and is frequently overbooked. Additionally, the triage system often shuts down after reaching capacity, leaving many patients without assistance and waiting weeks for appointments.



Solution

While we understand that securing the contract with ALBA was challenging, it does not excuse the fact that they are providing inadequate care, and their capacity fails to meet demand. South Lanarkshire Council should address the problems with the NHS services provided by ALBA to the national government, emphasizing the need to ensure that capacity meets demand and that patient care remains the central priority.

We also propose the opening of a new GP surgery, operated under a separate partnership from ALBA. This would, at the very least, help alleviate the existing demand.

Furthermore, the extended healthcare team at Woodstock is overworked. These services should be expanded, with an increased number of nurses, administrative staff, and other healthcare professionals. Such measures would significantly improve the quality of care and overall service delivery.

Proposals: Housing + Developments

Strengths

Lanark's distinctive townscape reflects a diverse mix of building types and sizes, developed gradually within the town centre and surrounding residential neighbourhoods. Housing ranges from town centre flats to executive homes. Over the centuries, the Royal Burgh has avoided sprawling, monotonous housing schemes, maintaining a balanced and varied character. While the historic conservation area, containing multiple listed buildings, has protected Lanark's historic charm.

Problem

There is a lack of varied housing in Lanark. Future housing plans should include a variety of housing to suit the needs of all current and prospective residents. Including but not limited to, housing for the elderly, disabled and families as well as encouraging bespoke/luxury low density, high amenity housing which will also bring captains of industry to Lanark, in turn, improving the economy.

Large-scale developments, like the Barracks, dominate the housing allocation, but Lanark would benefit more from smaller, incremental sites that suit its semi-rural character.

Town centre sites earmarked for housing association developments have remained vacant since the 1980s. These locations are often overlooked in favour of easier development options. A solution is needed to encourage cost-effective, architecturally sympathetic projects that make use of these spaces, while adhering to the conservation area's guidelines, ensuring any new developments complement Lanark's historic character.

Solution

- Prioritizing housing for the elderly and disabled in town centre developments.
- Social housing should be situated outside the town centre, where parking capacity, play spaces, and air quality better support general needs housing.
- Affordable homes for first-time buyers and families should be in more spacious areas, away from congested streets.
- Luxury/bespoke, low-density, high-amenity housing would be best suited to the town's outskirts, where it can take advantage of scenic views.
- New town centre developments adhere to the conservation area guidelines and retain Lanark's historic character.

Problem

The housing land supply in Lanark lacks a choice of smaller sites capable of being developed by locally-based companies employing local tradesmen.

Solution

We hope the sites that we've ear marked would roughly accommodate up to 50/100 houses, will be given due consideration. Plus, any town centre developments, for it to be a priority that they are considered for the elderly and disabled.

We suggest focusing on a mix of:

- Affordable homes for families and first-time buyers
- Luxury/bespoke, low density, high amenity housing to boost the local economy
- Homes for the elderly and disabled
- Rental properties
- Social housing

Proposals: Housing + Developments cont.

Recommended Development Sites

- Old St Mary's Hospital Site on Carstairs Road: Ideally placed for further housing development. (Map 1.1)
- Land on Hyndford Road, South-east of the Beeches: Suitable for several hundred new homes. (Map 1.2)
- The Old Council Yard off of Delves Road across from the entrance to Glenmuir factory. (Map 1.3)
- Site at Smyllum next to St. Mary's Primary School is of very limited agricultural value and is mainly used by dog walkers, a limited extension to Thomas Taylor Avenue would open up this site for development. (Map 1.4)
- The site of former Newmains Farm off Whitelees road (Map 1.5)
- The site of the former Caledonian Oil Works/ Tinto Construction Yard. (Map 1.6)
- The former site of AHS Packers (Map 1.7)
- 2 pieces of land at Old Bridgend and Lanark Road before Kirkfieldbank Bridge, (Map 1.8)

Maps of the proposed sites can be found on the following page with larger versions in the appendix.

By focusing on these areas, we can ensure a balanced and thriving community in Lanark.



The Old Council Yard on Delves road in its current state

Proposals: Housing + Developments

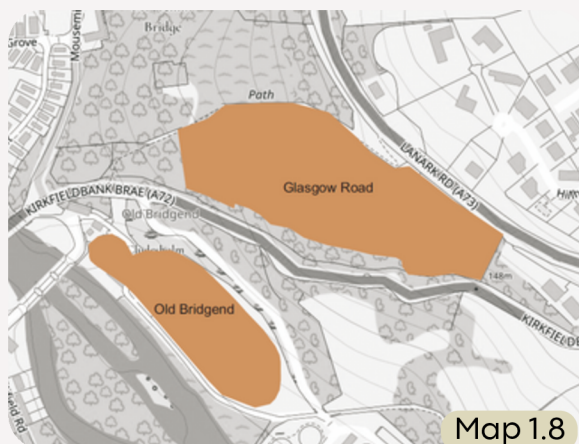
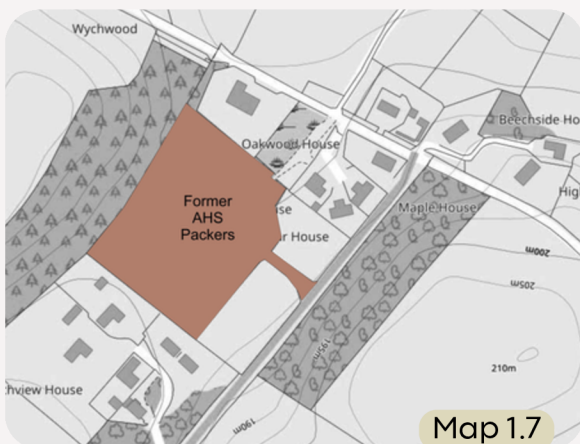
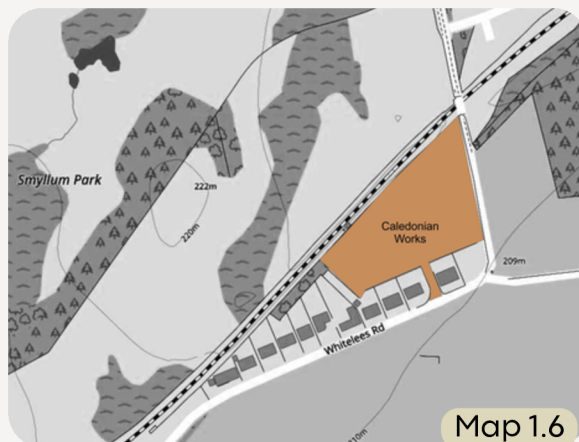
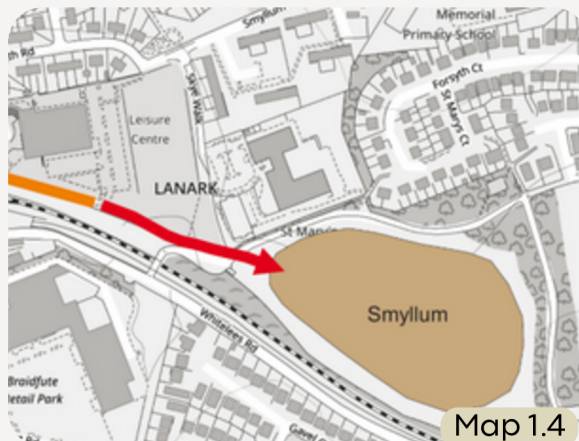

Proposals: Public Spaces

Delves Park

Problem

Delves Park has been neglected and is overdue improvements. The roadway through the park is in a very bad state with ruts and potholes, which seem as though little maintenance has been done to it since being gifted to the council in 1928. Other than the small children's play area, which is infrequently used, this park is a blank canvas that could be turned into something interesting that the community would use more frequently.

Solution

The path should be repaired, levelled out and rid of the potholes. The playpark should be expanded and improved, fixing the current equipment and adding others, a competition could be held amongst local schools for options to consider.

An outdoor gym could be included in Delves park, something a lot of towns have, this will hopefully motivate people to exercise that otherwise have financial barriers restricting them from using the other gyms in the town.

One of the main users of Delves Park are dog walkers, this could be utilised to create a dog park, an area that is fenced off protecting the dogs from any passing cars and running out of the park.

Lanark Racecourse

Problem

This area was the subject of a public consultation carried out by South Lanarkshire Council, and so far, no action has been taken since the reports release.

It is a wonderful resource for local people but is not fulfilling its potential.

The fencing along the side of the main road is broken down and dilapidated, the various footpaths and cycle paths through the woodland are neglected. The Tote Building, in spite of a great deal of common good money being spent on it, looks no more presentable than it did previously

Solution

The racecourse has potential to be the site of an integrated Sports Centre which could incorporate changing rooms, the current football pitches, the Rugby Club, an indoor tennis court, five-a-side football and a climbing wall. As well as other facilities such as toilets and a cafe.

Motor Home parking could also be made available with electricity plug in points, water and waste disposal available.

This would be a vital facility for young people and could include a youth hub for other activities indoors. The tote building would be able to serve as the entrance providing a mix of old and new architecture. Funding for this would be accessible through - heritage grants, youth grants and sports grants.

Young People

Problem

A number of young people in Lanark have been behaving antisocially and something needs to be done to prevent this. Damage has been done to multiple areas of Lanark including Atholl house, the old Lidl building and Castlebank park. Universal connections on Bannatyne street does a great job at providing activities for multiple ages, but there is only so much they are able to do to occupy the age group causing the issues.

Solution

As previously stated, the development of the racecourse provides a unique opportunity to create a space for young people of all ages. However, there are other areas that have potential, the unused smaller retail units at Braidfute retail park are suitably located close to Lanark Grammar. The Pump track, which is proposed for Kildare Park, has our support, and holds promise for the same age group.

Proposals: Public spaces cont.

Public Arts Trail

Problem

Lanark has a rich history it can celebrate in the public realm to attract tourism. At the moment small steps, using various mediums, have been made by local organisations to highlight the historic nature of Lanark, which have proven to be successful. The success of the installations currently in place proves there is scope for more projects of this type. Lanark is a walkable town and lends itself to the idea of a public arts trail.

Solution

More installations should be put in place around the town, on top of creating a public art strategy. Some examples of areas with public art strategies are Falkirk, Birmingham and Dublin.

Some ideas to include are:

- Gable end murals
- Painting the electricity boxes
- Statues
- Utilising some of the unique closes by having them painted according to their history (e.g. Bulls close could have a bull painted along it, Wide close could have an Elephant painted inside)

The installation of public art pieces throughout the town, strategically placed murals, and/or interactive exhibits in key locations, can create a captivating art trail that draws people to explore the town's history and natural beauty, increasing footfall and tourism.



Delves Park



Veitch's Close



Castlegate car park



Wallace House site

Appendix

When presenting our draft at the community consultation held on the 9/11/24, most feedback was positive and reinforced the proposals we had put in place, there were a few additions as noted on page 9, which have also been included here. These additions were chosen based on how frequently they were mentioned throughout the day. For example, 95% of people who attended commented on the old Lidl car park having become a necessity.

We also took into consideration areas that might have been developed or will be developed in the future, with hopes to change the outcome.

Additions were also made upon meeting with the Community Council on a regular basis as well as Discover Lanark members and Lanark Community Development Trust board meetings.

All Census data was acquired from the Scotland Census site using 'Census Locality 2022' location type at: www.scotlandscensus.gov.uk

Amendments from Consultation on the 9/11/24

- The Old Lidl Car Park has become vital to locals and visitors alike, when events are on this is felt more so. Locals feel this should be kept on top of any additional parking mentioned.
- Introducing a link for cars between Woodstock Road and St. Leonards Street to reduce congestion at the Woodstock Road/Bannatyne Street area.
- Work with Lanark Thistle Bowling Club to improve interpretation at the former site of Lanark Castle and include the site in the proposed public art trail.
- More opportunities for young people in the area.

A link to the documents that helped create this Local Place Plan can be found here:

<https://www.dropbox.com/scl/fo/mgmlojcctflmiqfhd5h5y/ACIE63HrZQICEwA53lgmJS A?rlkey=gfku6lldp2t69qqht9ql4qvsvr&st=8uwtw2x2&dl=0>



Artists Impression of transport hub



Appendix

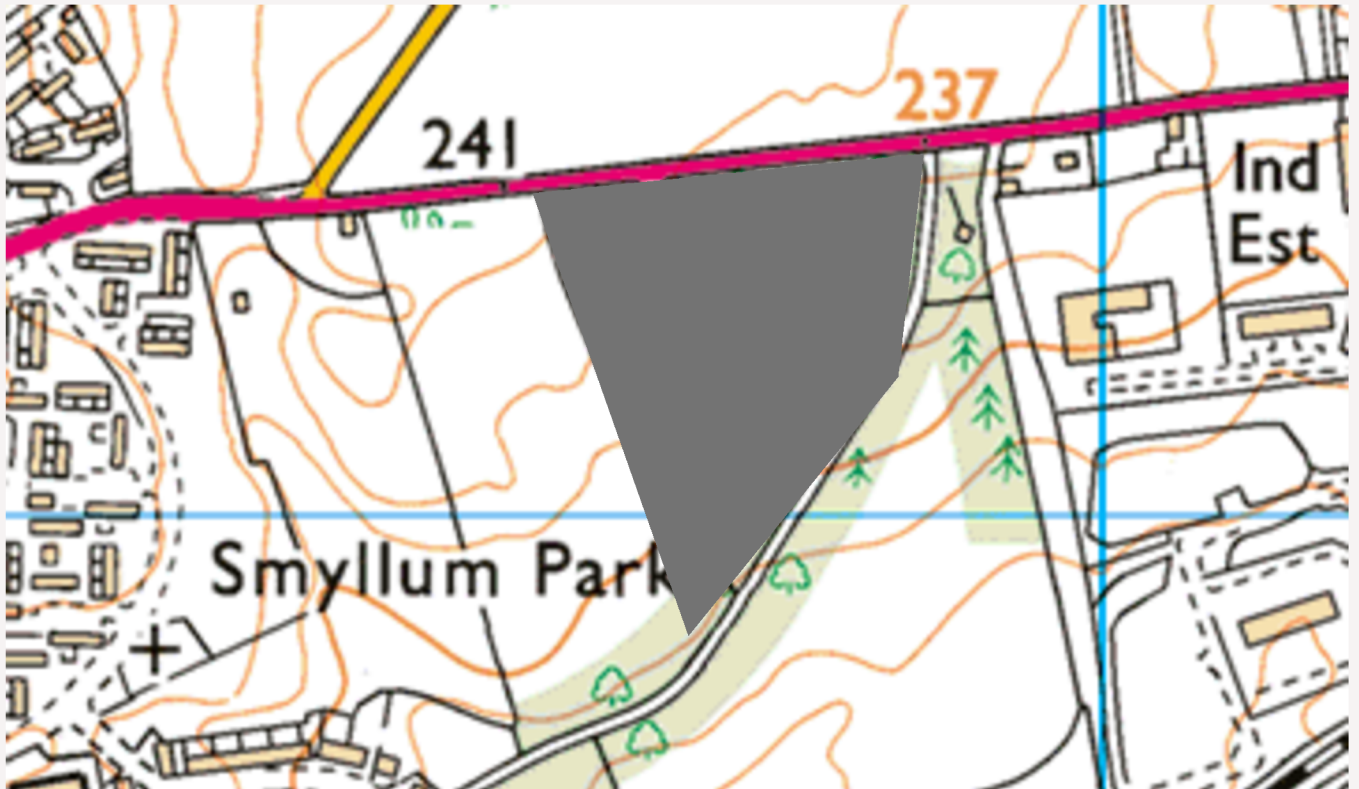

Map 1.1

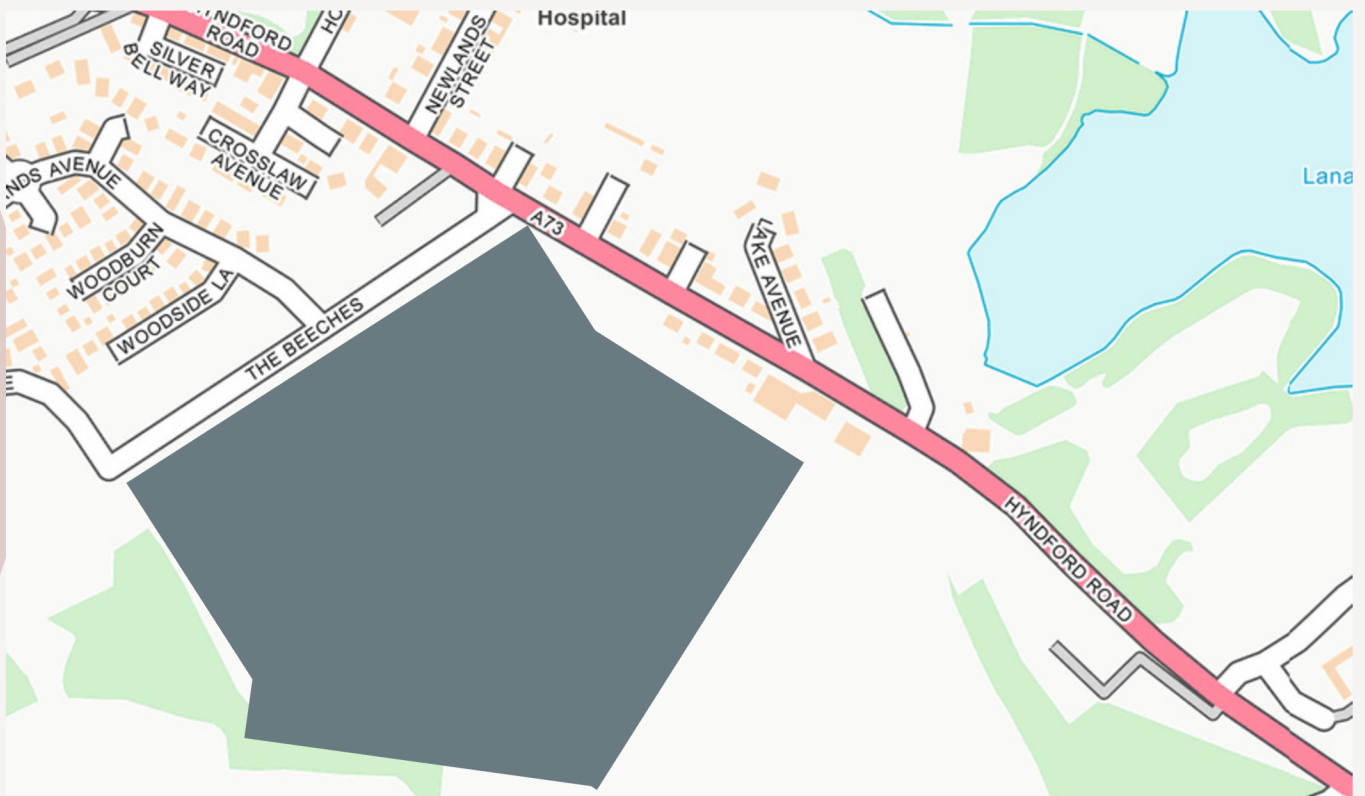

Map 1.2

Appendix



Map 1.3

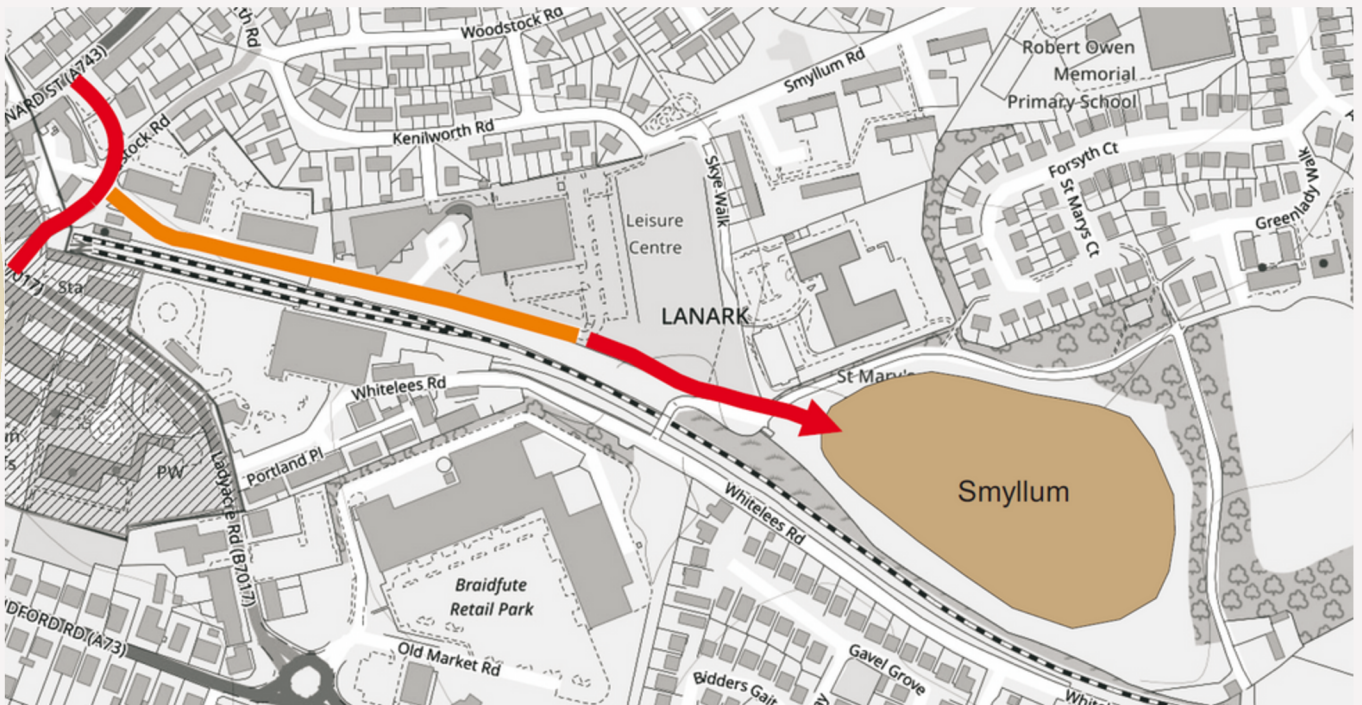

Map 1.4

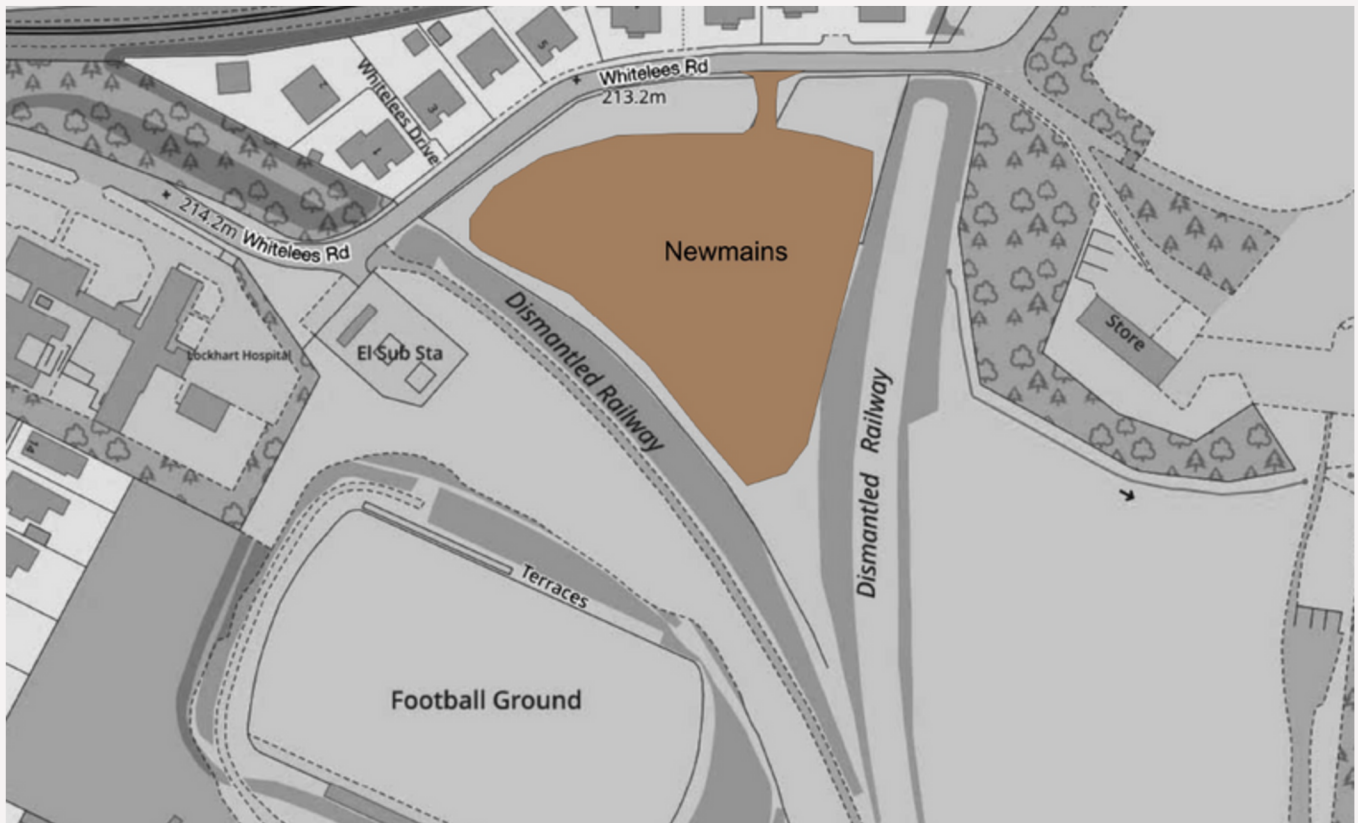

Map 1.5



Map 1.6



Map 1.7



Map 1.8